

# HOW TO APPLY TILES

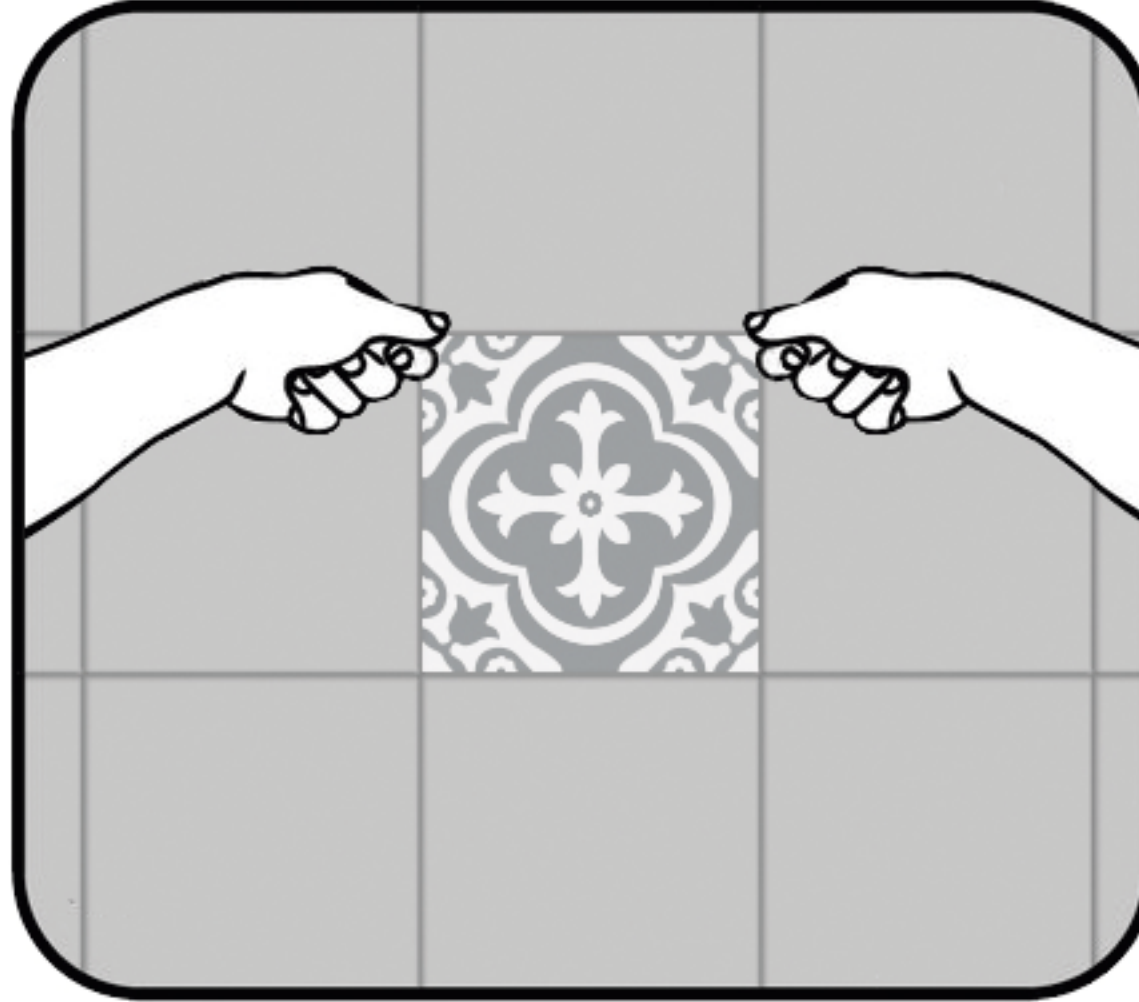

1. Clean the surface, if possible use a degreaser. Make sure the surface is free of dust, dirt and moisture. Let it dry and apply the tile stickers.



2. Align the tile sticker with the top of the tile.

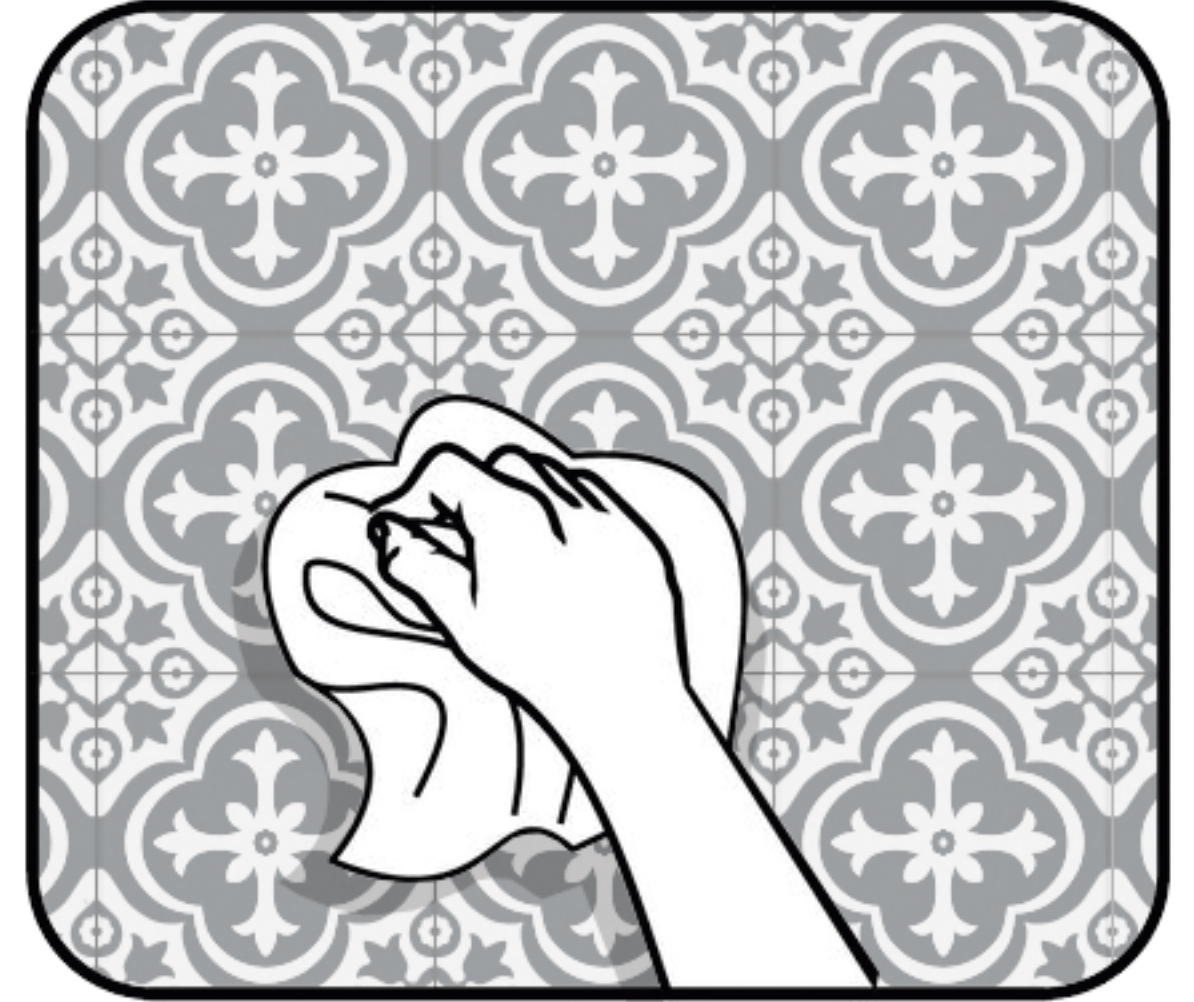

3. Adjust as needed then press firmly with a smooth cloth from top to bottom, carefully pushing out any air bubbles.

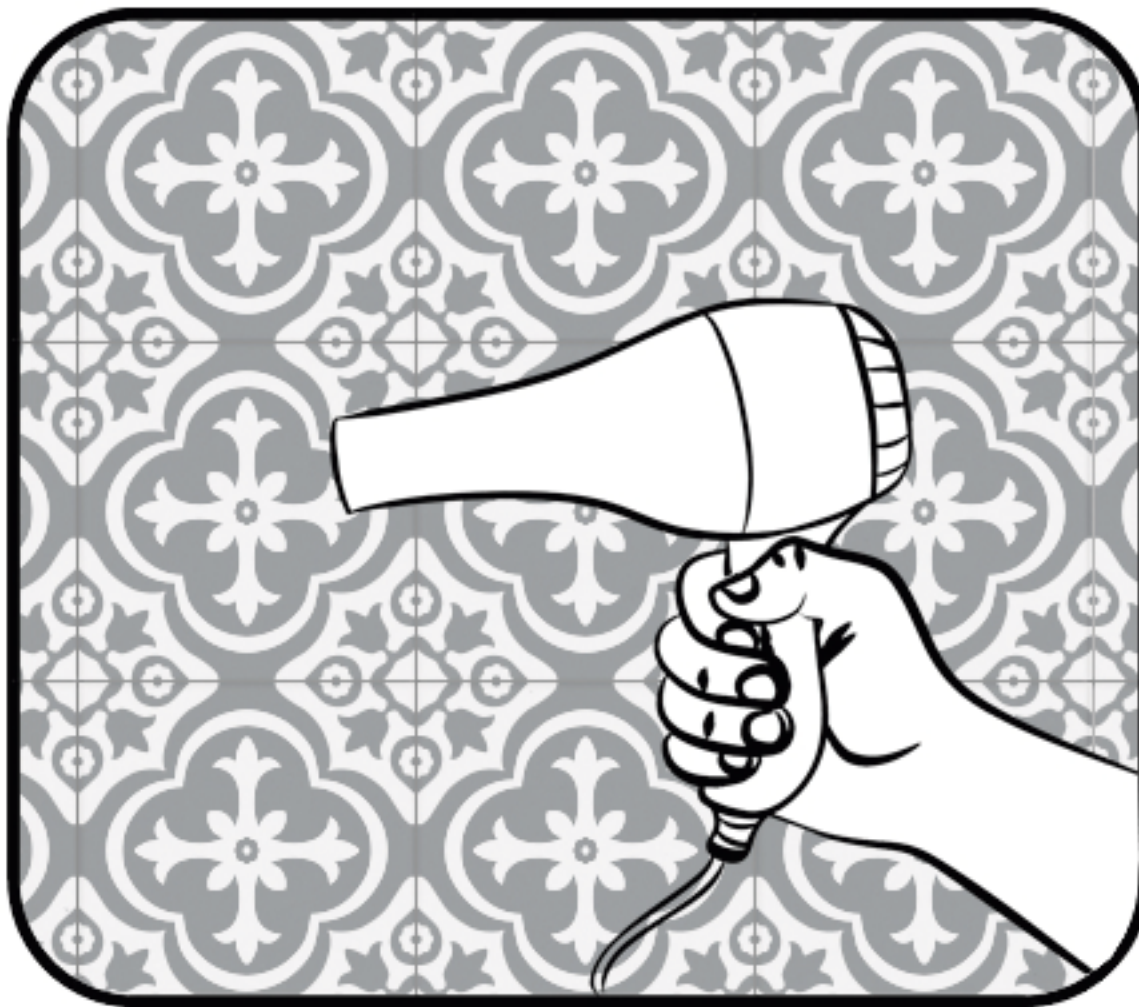

4. With a hair dryer apply some heat to the tile stickers to activate the glue and seal it. Make sure you do this process on the edges.

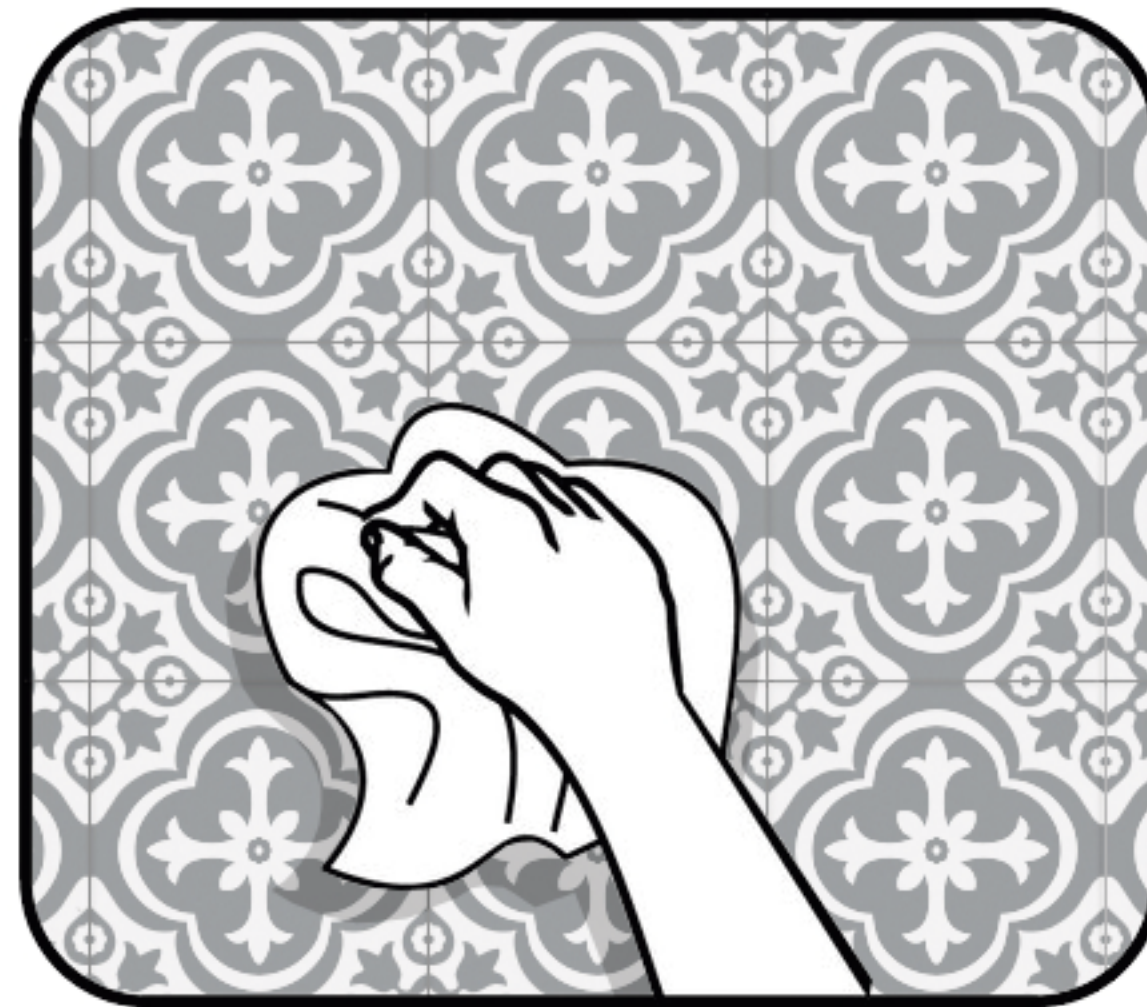

5. While applying heat use a smooth cloth and press firmly for a perfect finish and longer durability.